



**EMERGENCY SHELTER  
PRODUCTION PLANT  
FROM RECYCLED PLASTIC**

2019

Easy and fast to assemble,  
reliable and safe to live in,

 **PROMEKO**® has engineered

**A COMPLETE TURNKEY PLANT**

designed to manufacture

with **PLASTIC WASTE**

**ECONOMICAL LIVING UNITS**

ideal in any emergency situation when

**IMMEDIATE HOUSING** is required

from PLASTIC to PROFILE PLANT

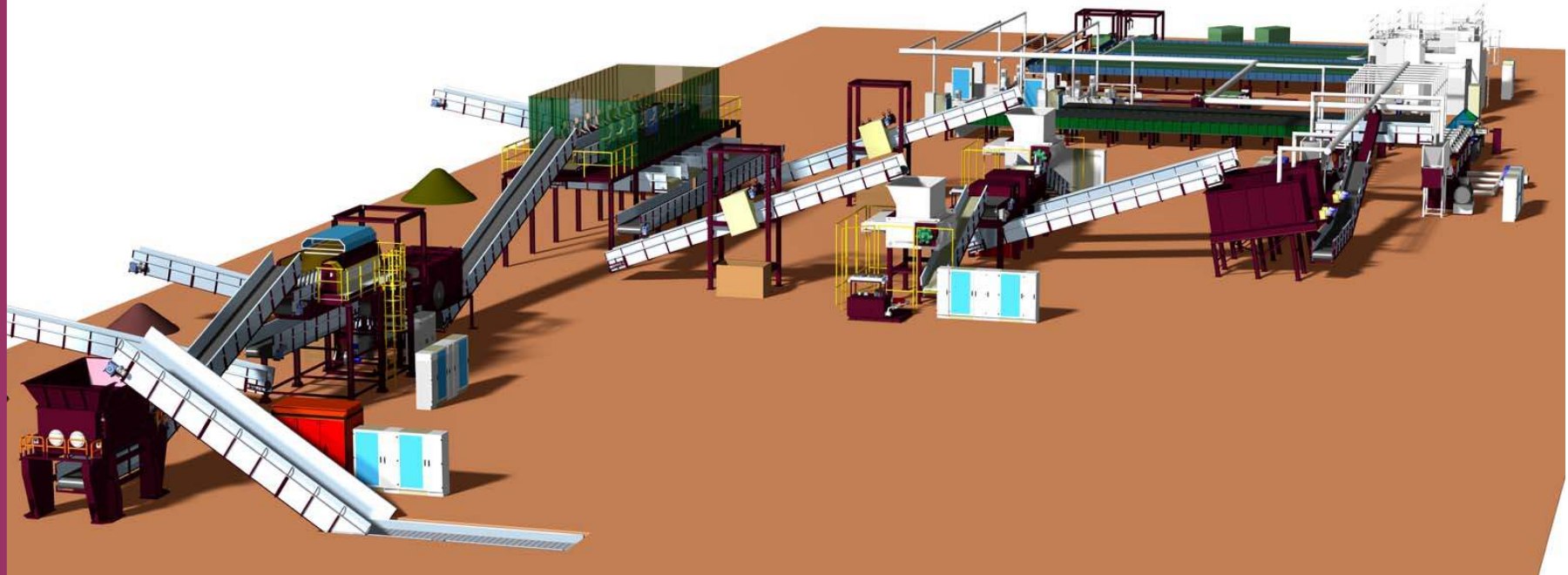

ENGINEERED & MANUFACTURED BY **PROMEKO®**

## INPUT MATERIAL

<b>Film - polyolefin</b>	<b>75%</b>	<b>375 kg/h</b>
<b>HDPE</b>	<b>20%</b>	<b>100 kg/h</b>
<b>Paper</b>	<b>5%</b>	<b>25 kg/h</b>
<b>Cardboard</b>		
<b>Wood</b>		
<b>HDPE</b>		
	<b>100%</b>	<b>500 kg/h</b>

## MADE OF RECYCLIGN PLASTIC

Size: width 300mm - length 2,500mm - thickness 30mm  
with tongue and groove joints  
honeycomb structure





**3,5 million people**  
still live in tents  
worldwide  
because of natural  
disasters such as  
floods, tsunami,  
earthquakes,  
hurricanes or in  
UNHCR refugee  
camps

## THE ALTERNATIVE

**IS OUR SOLID, INSULATED, CHEAP, EASY  
AND RELIABLE EMERGENCY SHELTER**



## LIVING UNIT DATA

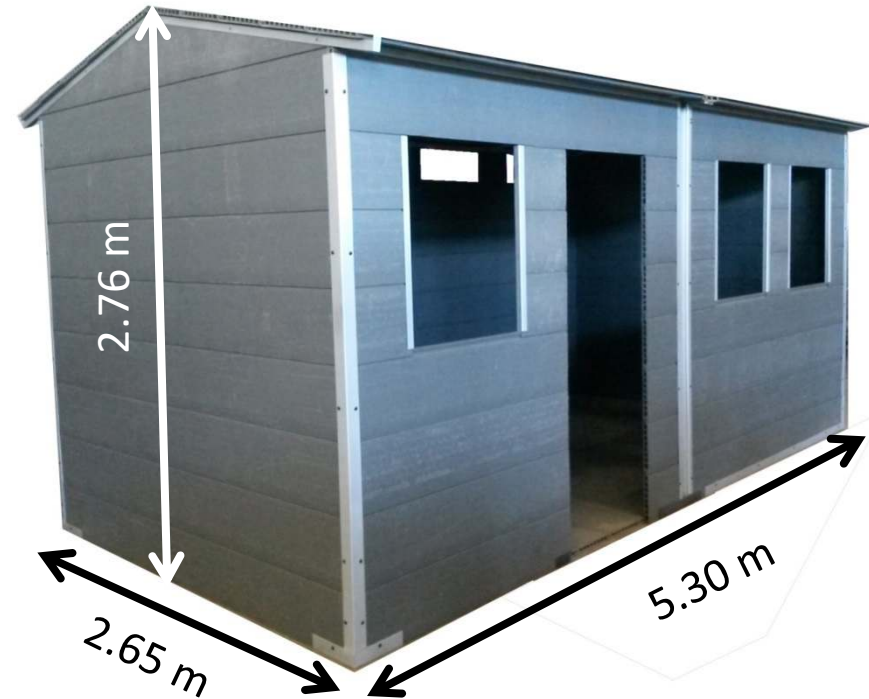

- Floor area: 14 sqm
- Weight: 1,100 kg
- Volume on a pallet: 2.70 mc
- People hosted per unit: 4



## PRODUCTION

1,000  
kg/hour  
per line

6,500 units  
per year

shelters for  
26,000  
people

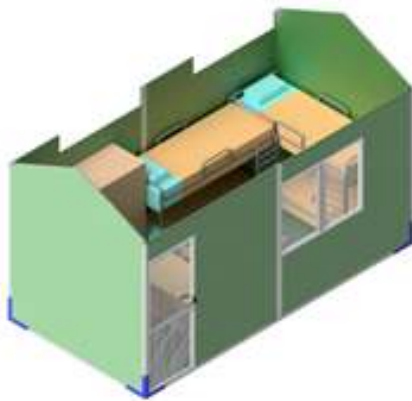



[www.promeco.it](http://www.promeco.it)  
[promeco@promeco.it](mailto:promeco@promeco.it)  
ITALY